

 DRAPER®

COMBINATION LOCK WALL-MOUNTED KEY BOX

Stock No. **03387** Part No. **KL3**

Read this manual in full before attempting to use this product and retain it for later use. Always use the latest version of the manual.



1. Health and Safety Information

- When installing the key box, read and understand all instructions and safety information relating to any tools required.
- Be aware of any electrical cables that may be present within the wall upon which the key box is to be mounted.
- Keep fingers clear of the edges and hinges when opening and closing the door.

2. Setting a New Combination

1. Open the shutter to access the combination wheels (Fig. 1).
2. Rotate the combination wheels until the current combination reads across the centre line (Fig. 2).
Important: The default code as shipped is **0000**. Draper Tools highly recommends that you change this code before use.
3. Press and hold the lever down and pull the door open using the tab at the top (Fig. 3).
4. Slide the **RESET** switch into position **B** (Fig. 4).
5. Rotate the wheels so that the desired combination reads across the centre line, then slide the **RESET** switch into position **A** (Fig. 5).

6. Place the item inside the box and close the door so that it clicks into place (Fig. 6).
7. Scramble the combination wheels and close the shutter.

3. Opening the Key Box

1. Open the shutter and rotate the combination wheels until the configured combination reads across the centre line.
2. Press and hold the lever down and pull the door open using the tab at the top.
3. When closing the box, ensure that the box clicks firmly into place before scrambling the combination wheels and closing the shutter.

4. Installation

1. Open the door and position the key box against the wall or surface.
2. Check that the key box is square and mark the position of the holes.
3. Remove the key box and drill the holes as appropriate.
Important: Observe all applicable Health and Safety guidance when drilling.
4. Align the key box with the holes and insert the appropriate screws tightly.
5. Close the key box door and scramble the combination wheels.

5. Notes on use

When setting a new combination, always ensure that the combination wheels are viewed directly from the front at a level eye-line. The chosen numbers must align with the centre line visible across the wheels. Misalignment when setting the combination may cause the key box to jam closed (Fig. 7).

DO NOT force the door. Oversized objects may damage the interior and prevent the door from opening and closing properly.

6. Care and Disposal

- Keep the shutter closed when not in use to reduce the likelihood of moisture affecting the combination wheels.
- Keep the combination wheels free from dust and dirt to prevent jamming.
- Be aware of corrosion and wear to the combination wheels and mechanism; this may compromise the functionality or integrity of the locking mechanism.

At the end of its working life, or when it can no longer be repaired, dispose of this product in accordance with local regulations.

Copyright © Draper Tools Limited



Fig. 1



Fig. 2

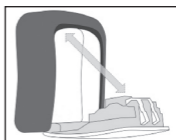

Fig. 3

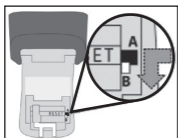

Fig. 4



Fig. 5

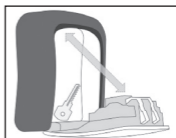

Fig. 6

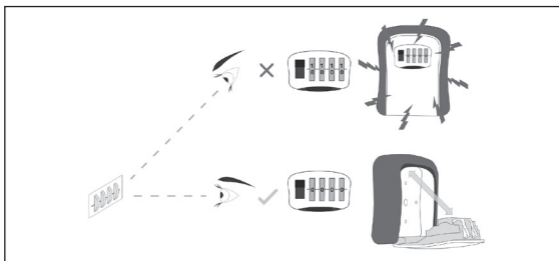

Fig. 7

Helpline: +44 (0) 23 8049 4344 Sales Desk: +44 (0) 23 8049 4333
General Enquiries: +44 (0) 23 8026 6355 Website: drapertools.com
Email: sales@drapertools.com