



DRAPER[®]

DIAGNOSTIC & ELECTRONIC **SERVICE TABLET**

12044



These instructions accompanying the product are the original instructions. This document is part of the product, keep it for the life of the product passing it on to any subsequent holder of the product. Read all these instructions before assembling, operating or maintaining this product.

This manual has been compiled by Draper Tools describing the purpose for which the product has been designed, and contains all the necessary information to ensure its correct and safe use. By following all the general safety instructions contained in this manual, it will ensure both product and operator safety, together with longer life of the product itself.

All photographs and drawings in this manual are supplied by Draper Tools to help illustrate the operation of the product.

Whilst every effort has been made to ensure the accuracy of information contained in this manual, the Draper Tools policy of continuous improvement determines the right to make modifications without prior warning.

1. TITLE PAGE

1.1 INTRODUCTION:

USER MANUAL FOR: Diagnostic & Electronic Service Tablet

Stock No: 12044

Part No: FCR-MOT

1.2 REVISIONS:

Date first published March 2018.

Date first revision December 2020.

As our user manuals are continually updated, users should make sure that they use the very latest version.

Downloads are available from: <http://drapertools.com/manuals>

Draper Tools Limited
Hursley Road
Chandler's Ford
Eastleigh
Hampshire
SO53 1YF
UK

Website: drapertools.com

Diagnostic helpline: +44 (0) 330 0552100

Diagnostic help email: diagnostic-support@drapertools.com

1.3 UNDERSTANDING THIS MANUALS SAFETY CONTENT:

WARNING! – Information that draws attention to the risk of injury or death.

CAUTION! – Information that draws attention to the risk of damage to the product or surroundings.

1.4 COPYRIGHT © NOTICE:

Copyright © Draper Tools Limited.

Permission is granted to reproduce this publication for personal and educational use only. Commercial copying, redistribution, hiring or lending is prohibited.

No part of this publication may be stored in a retrieval system or transmitted in any other form or means without written permission from Draper Tools Limited.

In all cases this copyright notice must remain intact.

2. CONTENTS

1. TITLE PAGE	
1.1 INTRODUCTION.....	2
1.2 REVISION HISTORY	2
1.3 UNDERSTANDING THIS MANUAL	2
1.4 COPYRIGHT NOTICE	2
2. CONTENTS	
2.1 CONTENTS	3
3. GUARANTEE	
3.1 GUARANTEE	4
4. INTRODUCTION	
4.1 SCOPE.....	5
4.2 SPECIFICATION	5
5. HEALTH AND SAFETY INFORMATION	
5.1 GENERAL SAFETY INSTRUCTIONS	6
5.2 SPECIFIC SAFETY INSTRUCTIONS.....	6
6. TECHNICAL DESCRIPTION	
6.1 IDENTIFICATION	7
7. UNPACKING AND CHECKING	
7.1 PACKAGING	8
7.2 WHAT'S IN THE BOX?.....	8
8. PREPARATION & CONNECTIONS	
8.1 VEHICLE TO TABLET CONNECTION.....	9
8.2 VCI CONNECTOR	10
8.3 CHARGING & TURNING ON.....	10
8.4 NETWORK SETUP.....	10
9. REGISTER & UPDATE	
9.1 REGISTER & UPDATE	11
10. CONNECTION	
10.1 PREPARATION	12
10.2 LOCATE VEHICLE'S DLC	12
10.3 CONNECTION	12
11. START DIAGNOSTICS	
11.1 START DIAGNOSTICS	13
12. DISPOSAL	
12.1 DISPOSAL	14
DECLARATION OF CONFORMITY	ENCLOSED

3. GUARANTEE

3.1 GUARANTEE

Draper tools have been carefully tested and inspected before shipment and are guaranteed to be free from defective materials and workmanship.

Should the tool develop a fault, please return the complete tool to your nearest distributor or contact:

Draper Tools Limited, Chandler's Ford, Eastleigh, Hampshire, SO53 1YF. England.

Telephone Sales Desk: (023) 8049 4333 or:

Diagnostic Helpline: +44 (0) 330 0552100.

A proof of purchase must be provided.

If upon inspection it is found that the fault occurring is due to defective materials or workmanship, repairs will be carried out free of charge. This guarantee period covering parts/labour is 12 months from the date of purchase except where tools are hired out when the guarantee period is 90 days from the date of purchase. The guarantee is extended to 24 months for parts only. This guarantee does not apply to normal wear and tear, nor does it cover any damage caused by misuse, careless or unsafe handling, alterations, accidents, or repairs attempted or made by any personnel other than the authorised Draper warranty repair agent.

Note: If the tool is found not to be within the terms of warranty, repairs and carriage charges will be quoted and made accordingly.

This guarantee applies in lieu of any other guarantee expressed or implied and variations of its terms are not authorised.

Your Draper guarantee is not effective unless you can produce upon request a dated receipt or invoice to verify your proof of purchase within the guarantee period.

Please note that this guarantee is an additional benefit and does not affect your statutory rights.

Draper Tools Limited.

4. INTRODUCTION

4.1 SCOPE

Advanced diagnostic tool, covering 48 vehicle manufactures and 10 service functions ,providing full EOBD II function,Oil reset, EPB, Battery management system reset, steering angle sensor reset, ABS brake bleeding reset, Diesel particular fuel reset, injector programming, Anti-theft matching, TPMS reset, Throttle matching,data record and replay, prints data via a PC, multilingual support- All updatable via the internet. Any other application is considered misuse.

4.2 SPECIFICATION

Stock No's.	12044
Part No's.	FCR-MOT
Rated input.....	5V --- 1A
Weight	0.56kg

Note: Draper Tools accepts no responsibility for any accident or injury arising from servicing the vehicles system. When interpreting results from the vehicle, always follow the manufacturer's recommendation for repair.

5. HEALTH AND SAFETY INFORMATION

5.1 GENERAL SAFETY INSTRUCTIONS

For your own safety and the safety of others, and to prevent damage to the equipment and vehicles. The safety messages presented below and throughout this user's manual are reminders to the operator to exercise extreme care when using this device. Always refer to and follow safety messages and test procedures provided by vehicle manufacturer. Read, understand and follow all safety messages and instructions in the full online manual.

Safety Message Conventions Used

We provide safety messages to help prevent personal injury and equipment damage. Below are signal words we used to indicate the hazard level in a condition.

DANGER

Indicates an imminently hazardous situation which, if not avoided, will result in death or serious injury to the operator or to bystanders.

WARNING

Indicates a potentially hazardous situation which, if not avoided, could result in death or serious injury to the operator or to bystanders.

CAUTION

Indicates a potentially hazardous situation which, if not avoided, may result in moderate or minor injury to the operator or to bystanders.

5.2 SPECIFIC SAFETY INSTRUCTIONS

And always use your scanner as described in this manual, and follow all safety messages.

WARNING

Do not route the test cable in a manner that would interfere with driving controls.

Do not exceed voltage limits between inputs specified in this user's manual.

Always wear approved goggles to protect your eyes from propelled objects as well as hot or caustic liquids.

Fuel, oil vapours, hot steam, hot toxic exhaust gases, acid, refrigerant and other debris produced by a malfunctioning engine can cause serious injury or death. Do not use the scanner in areas where explosive vapour may collect, such as in below-ground pits, confined areas, or areas that are less than 18 inches (45 cm) above the floor.

Do not smoke, strike a match, or cause a spark near the vehicle while testing and keep all sparks, heated items and open flames away from the battery and fuel / fuel vapours as they are highly flammable.

Keep a dry chemical fire extinguisher suitable for gasoline, chemical and electrical fires in work area.

Always be aware of rotating parts that move at high speed when an engine is running and keep a safe distance from these parts as well as other potentially moving objects to avoid serious injury.

Do not touch engine components that get very hot when an engine is running to avoid severe burns.

Block drive wheels before testing with engine running. Put the transmission in park (for automatic transmission) or neutral (for manual transmission). And never leave a running engine unattended.

Do not wear jewellery or loose fitting clothing when working on engine.

6. TECHNICAL DESCRIPTION

6.1 IDENTIFICATION

- ① Power button.
- ② Volume up/down button.
- ③ Back camera.
- ④ Storage for Vehicle Communications Interface.
- ⑤ Universal Serial BUS port.
- ⑥ 7 Inch colour touch screen.
- ⑦ Impact resistant case.
- ⑧ Front camera.
- ⑨ Speaker.

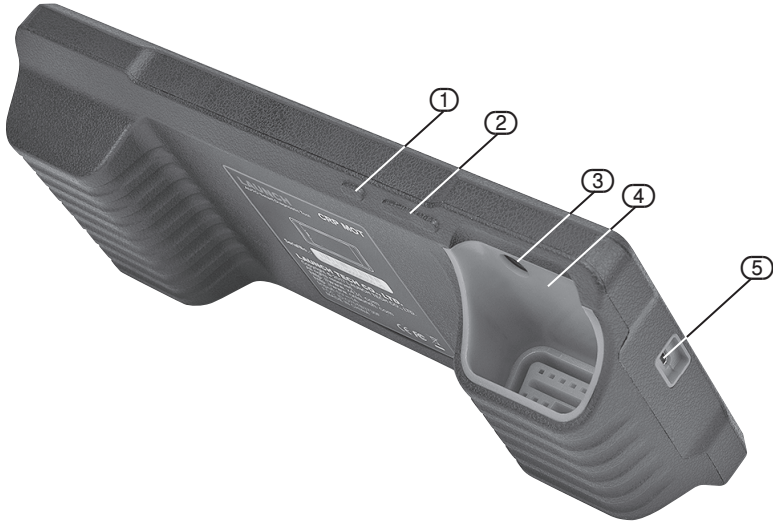

7. UNPACKING AND CHECKING

7.1 PACKAGING

Carefully remove the machine from the packaging and examine it for any sign of damage that may have happened during shipping. Lay the contents out and check them against the parts shown below. If any part is damaged or missing; please contact the Draper Helpline (the telephone number appears on the Title page) and do not attempt to use the machine.

The packaging material should be retained at least during the guarantee period: in case the machine needs to be returned for repair.

Warning! Some of the packaging materials used may be harmful to children. Do not leave any of these materials in the reach of children.

If any of the packaging is to be thrown away, make sure they are disposed of correctly; according to local regulations.

7.2 WHAT'S IN THE BOX?

The packaging contains several parts. Lay out the contents and check off the items against those featured below.



(10) Carry case.

(11) Vehicle to VCI adaptors.

(12) USB power cable.

(13) 230V to USB plug.

(14) VCI Wifi 16 pin connector.

8. PREPARATION & CONNECTIONS

8.1 VEHICLE TO TABLET CONNECTION

The system is mainly composed of tablet and VCI connector (14).

The following illustration explains how the tablet works with the VCI connector.

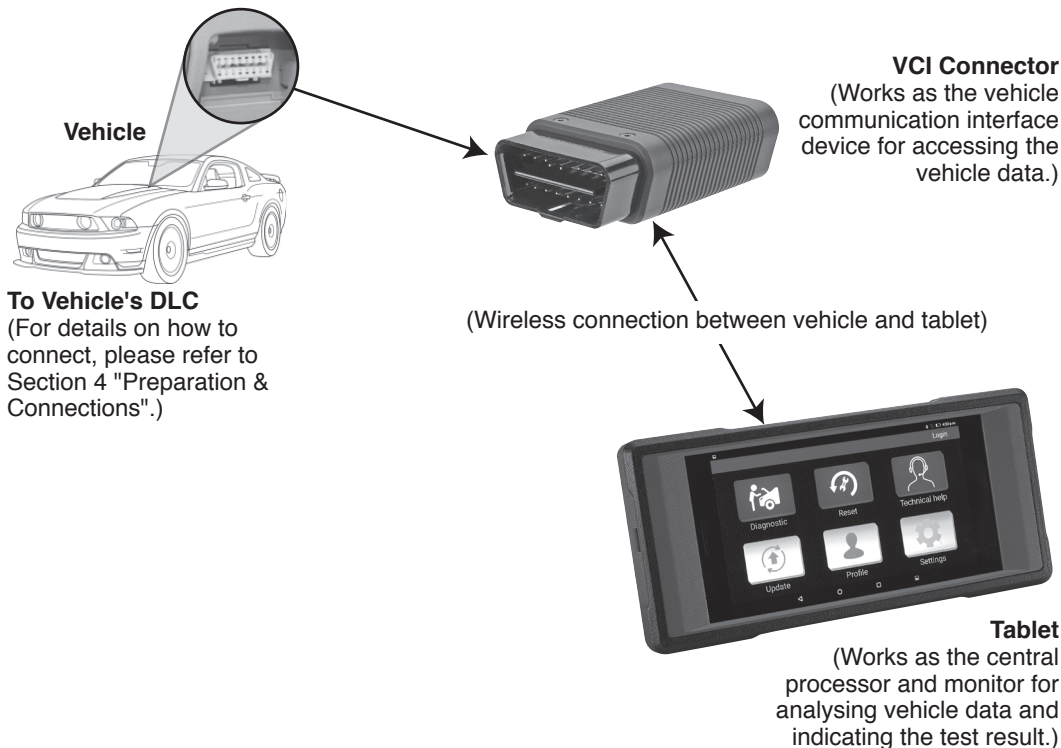

Network connection

To proceed one of the following operations, you need to make network connection (See Section 2 "Network Setup" for details):

- Register & activate, update the diagnostic software & APK.
- Surf the Internet.

Technical help

For technical help contact our tech team on

Diagnostic helpline: +44 (0) 330 0552100

Diagnostic help email: diagnostic-support@drapertools.com

8. PREPARATION & CONNECTIONS

8.2 VCI CONNECTOR

The VCI connector only applies to the passenger vehicles of 12V. It can be installed on the OBDII vehicle's DLC directly or via the extension cable.



OBD II 16pin connector
(For connecting to vehicle's DLC)

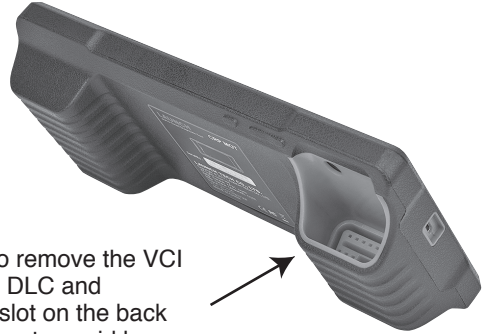

Note: Remember to remove the VCI connector from the DLC and re-insert it into the slot on the back of the tablet after use to avoid loss.

8.3 CHARGING & TURNING ON

1. Connect the power adaptor to the Universal Serial BUS port (5) of the tool.

2. If the tool is being charged:

A charging indicator displays.



Once the indicator turns, charging is complete.



3. Pressing the POWER button (1) will start the tool and enter the home screen.

Note: On first use of the tool, or if the tool remains idle for a long period of time, there may be insufficient battery power to start the tool. Please charge for a minimum of 5 minutes before attempting to turn it on again. Please use the power adaptor included within the kit to charge the tool. No responsibility can be assumed for any damage or loss caused as a result of using any power adaptor other than the one supplied.

8.4 NETWORK SETUP

This tablet supports WLAN connection.

1. On the home screen, tap "Settings"> WLAN.

2. Slide the WLAN switch to ON, the system starts searching for available WLAN networks.

3. Select a wireless network. If the chosen network is open CRP MOT will connect automatically, if the selected network is encrypted, a network password will need to be entered.

4. When "Connected" appears, it indicates the tablet is properly connected to the Internet.

*Note: when WLAN is not required this should be disabled to conserve battery power.

9. REGISTER & UPDATE

9.1 REGISTER & UPDATE

1. Launch App-> 2. Create an App Account-> 3. Activate VCI Connector-> 4. Download Diagnostic Software}

1. **Launch App:** Tap the application icon to launch it. Tap "Login" on the right upper corner of the screen.
 - a. For initial use, tap "New registration" to open a sign-up page, refer to steps 2~4.
 - b. If you have an account, tap "Login" to login directly.
 - c. If you forgot the password, tap "Retrieve password" to retrieve it.

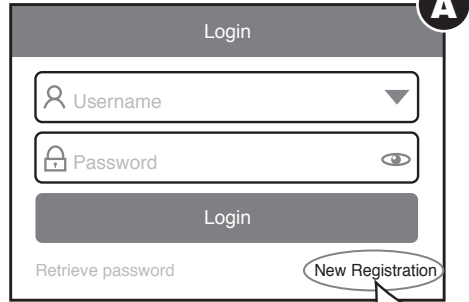

2. **Create Account:** In Fig. B, fill in each field and tap "Register" to go to step 3. (Note: To obtain more functions and better service, please enter the real information.)

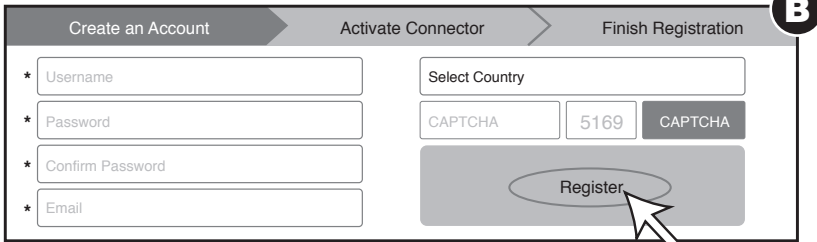

3. **Activate VCI Connector:** In Fig. C, input the Product S/N and Activation Code (can be obtained from the password envelope), and then tap "Activate".

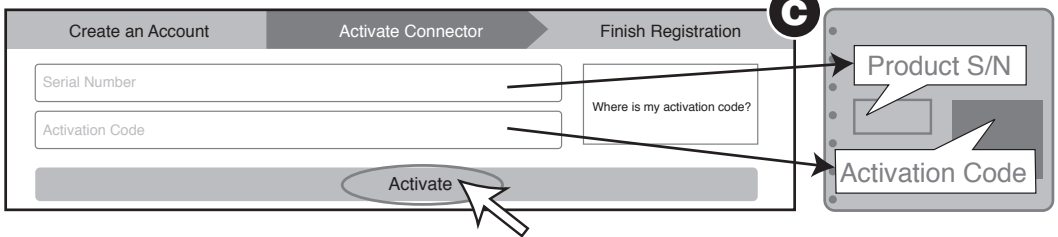

4. **Update Diagnostic Software:** Tap "Yes" in Fig. D to enter diagnostic software download screen. (Note: To download the software later, tap "No". In this case, tap "Software Upgrade" on the function menu to download it.)

Tap "Update" to download and install the diagnostic software. (Note: Be sure that the tool has a strong WLAN connection during downloading.)

Software updates for the first 12 months are included. Charges apply for subsequent software updates quote stock no. 94088.

For more information please contact our Customer Support helpline on +44 (0) 23 8049 4344.

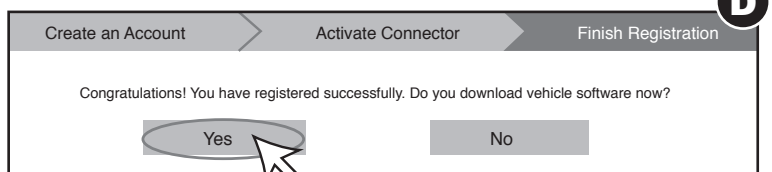

10. CONNECTION

10.1. PREPARATION

- 1) Switch the ignition on.
- 2) The vehicle battery voltage should be 9-14V.
- 3) Throttle should be in a closed position.

10.2 LOCATE VEHICLE'S DLC

The DLC (Data Link Connector) provides standard 16 pins and is generally located on driver's side, about 12 inch away from the centre of dashboard.

See Figure DLC Location. If DLC is not equipped under

dashboard, a label indicating its position will be given. In case no DLC is found, please refer to Automobile Repair Manual.

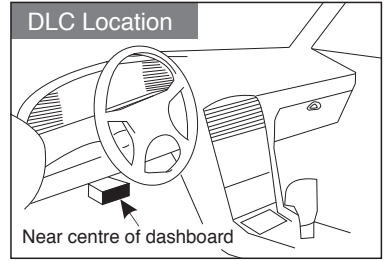

10.3 CONNECTION

Select the desired diagnostic connector according to the vehicle DLC type and then follow the steps below to proceed:

1. For vehicles equipped with an OBD 11 management system

Plug the VCI connector into the vehicle's DLC directly or use the OBD II extension cable to connect the VCI connector and the DLC.

2. For vehicles NOT equipped with an OBD 11 management system

Do the following:

- 1). Select the corresponding non-16pin connector.
- 2). Plug the non-16pin end of the connector into the DLC socket, then connect the other end to the OBD I adaptor, and then tighten the captive screws.
- 3). Connect the other end of the adaptor to the VCI connector.
- 4). To supply power to OBD I adaptor from:
 - A. Battery Clamps Cable (optional): Connect one end of the battery clamps cable to vehicle's battery, and the other end to the power jack of OBD I adaptor,
OR
 - B. Cigarette Lighter Cable (optional): Connect one end of the cigarette lighter cable to vehicle's cigarette lighter receptacle, and the other end to the power jack of OBD I adaptor.

11. START DIAGNOSTICS

11.1 START DIAGNOSTICS

For new users, follow the sequence below to start a new diagnostic session.

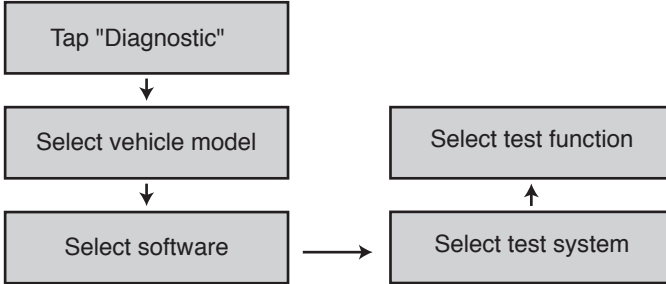

*Notes:

1. To start diagnosing a vehicle, you have to activate the VCI connector and download the diagnostic software. For details, refer to Section 3 "Register & Update" in this Quick Start Guide.
2. All software is updated from time to time. To enjoy more better service and functions, you are suggested to keep updated with the latest version.

All illustrations are for reference purpose only and this Quick Start Guide is subject to change without notice.

12. DISPOSAL

12.1 DISPOSAL

- At the end of the machine's working life, or when it can no longer be repaired, ensure that it is disposed of according to national regulations.
- Contact your local authority for details of collection schemes in your area.

In all circumstances:

- Do not dispose of power tools with domestic waste.
- Do not incinerate.
- Do not abandon in the environment.
- Do not dispose of WEEE* as unsorted municipal waste.



■
* Waste Electrical & Electronic Equipment.

CONTACTS

Draper Tools Limited, Hursley Road,
Chandler's Ford, Eastleigh, Hampshire. SO53 1YF. U.K.

Diagnostic Helpline: Tel. +44 (0) 330 0552100

Sales Desk: (023) 8049 4333

Internet: drapertools.com

Diagnostic Help Email: diagnostic-support@drapertools.com

General Enquiries: (023) 8026 6355

Service/Warranty Repair Agent:

For aftersales servicing or warranty repairs, please contact the Draper Tools Helpline for details of an agent in your local area.

YOUR DRAPER STOCKIST

DBC1220

©Published by Draper Tools Limited.

No part of this publication may be reproduced, stored in a retrieval system or transmitted in any form or by any means, electronic, mechanical photocopying, recording or otherwise without prior permission in writing from Draper Tools Ltd.