

EN

Original Instructions
Version 1

DRAPER[®]

12V 1200A LITHIUM **JUMP STARTER**

23724



**UK
CA** **CE**



IMPORTANT: This product must be charged immediately after purchase and recharged every 3 months to maintain its performance.

These are the original product instructions. This document is part of the product; retain it for the life of the product, passing it on to subsequent holders. Read this manual in full before attempting to assemble, operate or maintain this product.

This Draper Tools manual describes the purpose of the product and contains all the necessary information to ensure its correct and safe use. Following all the instructions and guidance in this manual will ensure the safety of both the product and the operator and increase the lifespan of the product.

All photographs and drawings within this manual are supplied by Draper Tools to help illustrate correct operation of the product.

Every effort has been made to ensure the information contained in this manual is accurate. However, Draper Tools reserves the right to amend this document without prior warning. Always use the latest version of the product manual.

1.1 Product Reference

User Manual for: Lithium Jump Starter

Stock No: 23724

Part No: GT1200

1.2 Revisions

Version 1: April 2024

First release

For the latest version of this manual and the associated parts list, if applicable, please visit drapertools.com/manuals.

1.3 Understanding the Safety Content of This Manual



WARNING! – Situations or actions that may result in personal injury or death.



CAUTION! – Situations or actions that may result in damage to the product or surroundings.

Important: – Information or instructions of particular importance.

1.4 Copyright © Notice

Copyright © Draper Tools Limited.

Permission is granted to reproduce this manual for personal and educational use **ONLY**. Commercial copying, redistribution, hiring or lending is strictly prohibited.

No part of this manual may be stored in a retrieval system or transmitted in any other form or means without written permission from Draper Tools Limited.

In all cases, this copyright notice must remain intact.

1. Preface	2
1.1 Product Reference	2
1.2 Revisions	2
1.3 Understanding the Safety Content of This Manual	2
1.4 Copyright © Notice	2
2. Contents	3
3. Product Introduction	4
3.1 Intended Use	4
3.2 Specification	4
4. Health and Safety Information	5-6
4.1 Vehicle Battery Health and Safety Precautions	5
4.2 Jump Starter Health & Safety Precautions	5
4.3 Rechargeable Battery Health & Safety Precautions	5
4.4 Flashlight Health & Safety Precautions	6
4.5 Residual Risk	6
4.6 Explanation of symbols	6
5. Identification and Unpacking	7-8
5.1 Product Overview	7
5.2 What's in the Box?	8
5.3 Packaging	8
6. Charging the Product	9
6.1 Charging the Jump Starter	9
6.2 Using as a Power Bank	9
7. Operating Instructions	10-11
7.1 Jump Starting the Vehicle	10
7.2 Using the built in Flashlight	11
8. Maintenance and Troubleshooting	12
8.1 General Maintenance	12
8.2 Troubleshooting	12
9. Disposal	13
10. Warranty	13

3. Product Introduction

3.1 Intended Use

This product has been designed as a compact and portable vehicle jump starter with a built-in flashlight. It can also be used as a powerful USB power bank supplying several full charges to most smart phones.

Any other application beyond the conditions established for use will be considered misuse. Draper Tools accepts no

responsibility for improper use of this product.

Read this manual in full before assembling, operating or maintaining the product, and retain it for later use.

3.2 Specification

Stock No.	23724
Part No.	GT1200
Net Weight:	489g
Dimensions (LXWXH):	176 X 83 X32mm
Voltage:	12V DC
Capacity:	12,000mAh
Peak Current:	1200A
Crank Current:	600A
Petrol Engine:	6L
Diesel Engine:	4L
Flashlight Power:	1W
USB-C Input:	5V/2A
USB Output 1:	5V/3A, 9V/2A, 12V/1.5A
USB Output 2:	5V/2.1A
DC Output:	15V/5A
Battery Type:	Lithium-ion
Charging Time:	Approx. 7½ hours
Storage Temperature:	-20°C to 60°C

4.1 Vehicle Battery Health and Safety Precautions



WARNING! Risk of explosive gases

- Working in the vicinity of lead-acid batteries is dangerous as they generate explosive gases during normal operation. Follow these instructions and those published by the battery manufacturer and the manufacturer of any other equipment to be used in the vicinity of the battery.
- Review warning marks on all these products and on the engine.
- When working near a lead-acid battery, ensure someone is within range of your voice or close enough to come to your aid.
- Never smoke or allow a spark or flame near the battery or engine.
- Take extra care not to drop a metal tool onto the battery. It could spark or short circuit the battery.
- Wear suitable eye and face protection.
- Have plenty of fresh water and soap nearby in case battery acid contacts eyes, skin or clothing. If acid enters eyes, wash eye under cold clean running water for at least 15 minutes and get medical attention immediately.
- Remove any metallic items such as rings, bracelets, necklaces and watches. A lead-acid battery can produce a short circuit current high enough to weld a metallic item, which may cause a severe burn.

4.2 Jump Starter Health & Safety Precautions

- Before using the jump starter refer to the vehicle's manufacturer instruction manual for specific advice on jump starting.
- Only trained and competent personnel may operate this device.
- Fully charge the jump starter before using for the first time.
- The jump starter is for use on 12V batteries only.
- **ONLY** use the clamps supplied with the starter unit.
- **DO NOT** use this unit if the clamp leads are damaged or worn.
- **NEVER** allow the clamps to touch one another or to connect to the same piece of metal, otherwise the jump starter will be damaged.

- **DO NOT** use the jump starter to start a damaged, bulging, or frozen car battery.
- **DO NOT** disassemble or modify the unit.
- **DO NOT** place or store the unit in a high temperature environment that exceeds 60°C. The storage temperature is -20 to 60°C.
- Handle the unit with care and if dropped or showing signs of damage get it checked by a qualified service person.



WARNING! DO NOT use this product if damage or defects are present; take it out of service until it has been repaired or replaced. Contact Draper Tools for repair and replacement options.

- Children should be supervised to ensure they do not play with the jump starter.
- Keep the product away from children and pets.
- Observe and adhere to all standard safety precautions and good practices when working in a workshop environment.
- Keep the work environment clear and well-lit, with bystanders at a safe distance.
- **DO NOT** use this product in wet conditions or expose it to rain.
- **DO NOT** use this product near flammable or combustible materials or in dangerous or explosive environments.
- Keep away from heat sources and do not leave for long periods of time in a hot car.

4.3 Rechargeable Battery Health & Safety Precautions

- **DO NOT** leave battery in a discharged state.
 - To maintain the battery health and performance charge the battery every 3 months.
- WARNING! To reduce the risk of burns or fire:**
- **DO NOT** attempt to open, disassemble, modify or service the jump starter.
 - **DO NOT** crush, puncture, short external contacts or dispose of in fire or water.
 - **DO NOT** expose to temperatures above 60°C.
 - **DO NOT** use this product if the casing is open, missing or damaged in any way.
 - **DO NOT** attempt to remove the built in battery as it is not replaceable.
 - **DO NOT** charge non-rechargeable batteries.

4.4 Flashlight Health & Safety Precautions

- **DO NOT** turn the light on when the jump starter is being charged.
- **DO NOT** shine the light directly into eyes.
- **DO NOT** allow children to use the light.

4.5 Residual Risk

The safety instructions in this manual cannot account for all possible conditions and situations that may occur. Exercise common sense and caution when using this product and protect against any additional conceivable risks.

4.6 Explanation of symbols



Read the instruction manual



Warning!



Wear face mask and safety glasses



Keep out of the reach of children



WEEE –

Waste Electrical & Electronic Equipment

Do not dispose of Waste Electrical & Electronic Equipment in with domestic rubbish



UK Conformity Assessed



European conformity

5.1 Product Overview



- (1) Jump starter lead port
- (2) Flashlight
- (3) 2 X USB output port
- (4) Jump starter
- (5) Display screen
- (6) ON/OFF button
- (7) DC output
- (8) USB- C Input
- (9) USB type-C charging cable

5. Identification and Unpacking

5.2 What's in the Box?

Carefully remove the product from the packaging and examine it for any signs of damage that may have occurred during shipment.

Before assembling the product, lay the contents out and check them against the parts shown below. If any part is damaged or missing, do not attempt to use the product. Please contact the Draper Helpline; contact details can be found at the back of this manual.

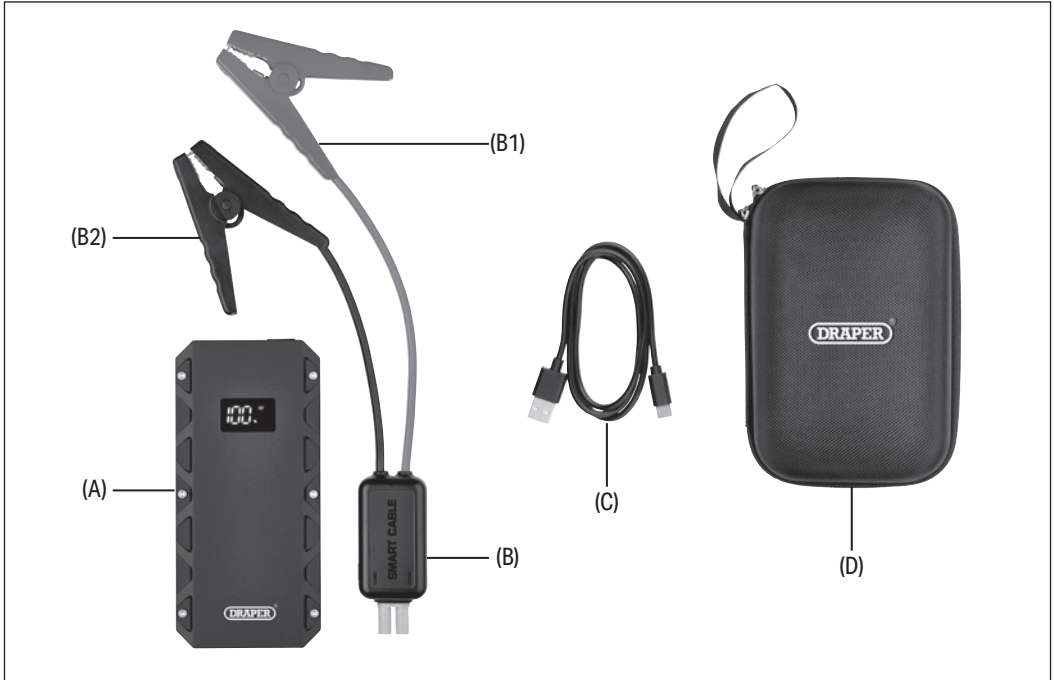

- A. 1 x Jump starter
- B. 1 x Intelligent jump leads
 - B1. 1 x Red clamp (+)
 - B2. 1 x Black clamp (-)

- C. 1 x USB-C cable
- D. 1 X Storage case

5.3 Packaging

Keep the product packaging for the duration of the warranty period in case the product needs to be returned for repair.



WARNING! Keep packaging materials out of reach of children. Dispose of packaging correctly and responsibly and in accordance with local regulations.

Please visit drapertools.com for our full range of accessories and consumables.

6.1 Charging the Jump Starter

Note: Before using for the first time, ensure that the jump starter is fully charged.

- **DO NOT** use the device while charging.
1. To begin charging, connect one end of the USB-C cable to the USB-C input port (8) and the other to a suitable power supply.
 2. Press the '**ON/OFF**' button (6) to turn on.
 3. During charging, '**IN**' will be displayed and the screen will turn off automatically once fully charged.
 - Charging time will take approximately 7½ hours.
 4. Unplug the cable when fully charged (100%).

6.2 Using as a Power Bank - Fig. 1.

1. Connect your smart phones, tablets, laptops or other electronic devices using the USB cable to either of the USB output ports (3) on the Jump starter.
2. Press the '**ON/OFF**' button once to start charging.
3. Unplug the cable when fully charged.

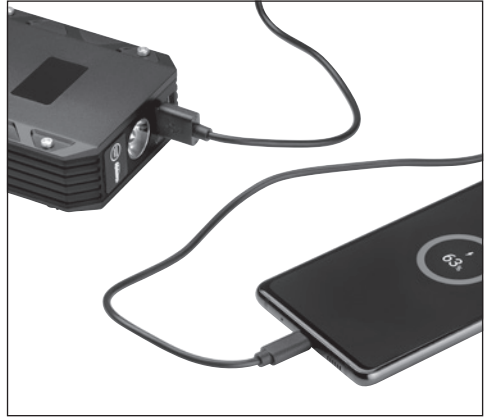

Fig. 1

Important: Before preparing or using this product, read and understand all the safety instructions listed in this manual.

7.1 Jump Starting the Vehicle - Fig. 2.

Note:

- This product is for 12V petrol 6 litre engine and diesel 4 litre engine cars only.
 - Before using the Jump Starter:
 - Check that the battery power is above 80%.
 - Refer to the vehicle's manufacturer instruction manual for specific advice on jump starting and follow their recommended process.
1. Lift up the port cover (1) and insert the connector end (B) of the clamps fully into the jump starter Port (1).
 2. With the engine turned off, connect the red clamp to the positive (+) terminal (or the vehicle's manufacturer's recommended jump point) and the black clamp to the negative (-) terminal of the car battery (or the vehicle's manufacturer's recommended jump point).
 3. Press the '**ON/OFF**' (6) button to turn on the jump starter.

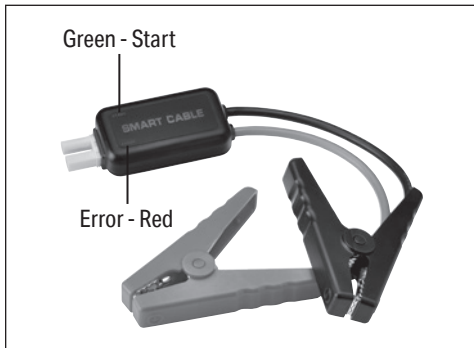

Fig. 2

Jump leads (B) indicators	Meaning
Green and red flashing	Clamps are connected correctly to the vehicle's battery.
Green only	Ready to start.
'Red Error' only	Voltage too low to start vehicle.

4. Start the car engine and allow 30 seconds between each attempt.
 - If unsuccessful after 3 attempts, to avoid damaging the jump starter stop and inspect the vehicle/ battery for potential issues.
5. Once the engine has been started, turn off the engine and remove the lead connector from the jump starter. Disconnect the jump starter clamps within 30 seconds removing the negative clamp first then the positive clamp.

6. Restart your car.

Note: The jump starter will turn off automatically when no load is detected.

7.2 Using the built in Flashlight

1. To operate the flashlight, press and hold the **'ON/OFF'** button (6) for 3 seconds or until the light comes on.
2. The light has 3 settings as follows:
3. To turn off the flashlight press the **'ON/OFF'** button until the light goes out.

Note: the jump starter display will remain off and will turn off automatically once no load is detected.

Press	Beam Setting
Once	On/High
X2	Strobe/Fast flashing
X3	S.O.S/Slow flashing

8.1 General Maintenance

- Check the battery level and recharge at least once every 3 months.
- Keep the product clean and free from dust, debris and grease.
- Use a dry clean cloth to clean the housing of the device.
- Do not use detergents to clean the product.
- When not in use store in a dry well-ventilated area, out of direct sunlight and out of the reach of children. The storage temperature should not exceed 60°C.

8.2 Troubleshooting

Problem	Possible cause	Remedy
Jump Starter Clamp Indicators		
Flashing red and green indicator.	Jumper cable connected.	/
Solid green indicator.	Ready to start.	/
Solid red indicator.	Low voltage protection.	Recharge the product.
Solid red indicator with continuous beeping and two short beeps	Short circuit protection.	Do not connect the clamps to each other or to the same metal surface, and let it cool down.
Solid red indicator with beeping.	Reverse polarity protection.	Swap the clamps and ensure the correct connection.
Solid red indicator with fast beeping.	Over-heating protection.	Disconnect the clamps and let it cool down.
Solid red and green indicator.	Timeout protection.	If the leads are connected but no starting action carried out, the intelligent lead will automatically switch off after 90seconds. Reconnect the leads to the jump starter.
Jump Starter Problems		
Jump start failed.	Battery power level too low.	Keep battery level above 80%.
	Poor connection due to rusty or dirty car battery terminals.	Clean the terminals and retry.
	Battery overheating.	Allow to cool down for 1 minute before retrying.
	The clamps are incorrectly connected.	Ensure the clamps are connected to the correct (+) and (-) terminals.
	Wrong battery voltage used.	Only suitable for vehicles with 12V batteries.
	Problem unrelating to vehicle's battery.	Inspect the vehicle for other issues.

- At the end of its working life, dispose of the product responsibly and in line with local regulations. Recycle where possible.
- **DO NOT** dispose of this product with domestic waste; most local authorities provide appropriate recycling facilities.
- **DO NOT** burn or mutilate batteries; this may release toxic or corrosive substances.



10. Warranty

Draper Tools products are guaranteed for 12 months to be free from defective materials and workmanship. Full details of the warranty period can be found on the Draper Tools Website.

Should the tool develop a fault within the warranty period, return the complete tool to the place of purchase or contact Draper Tools directly. Proof of purchase must be provided.

This warranty does not apply to any consumable parts or normal wear and tear.

It also does not cover any damage caused by misuse, careless or unsafe handling, modifications, or repairs carried out by any personnel other than an authorised Draper Tools repair agent.

Please note that this guarantee is in addition to and does not affect your statutory rights.

Draper Tools Limited

Contact Details

Draper Tools

Draper Tools Limited
Hursley Road
Chandler's Ford
Eastleigh
Hampshire
SO53 1YF
UK

Website: drapertools.com

Email: sales@drapertools.com

Product Helpline: +44 (0) 23 8049 4344

Telephone Sales Desk: +44 (0) 23 8049 4333

General Enquiries: +44 (0) 23 8026 6355

Delta International

Delta International BV
Oude Graaf 8
6002 NL
Weert
Netherlands

Please contact the Draper Tools Product Helpline for repair and servicing enquiries.