

DRAPER®

INSTRUCTIONS FOR **Aluminium/Steel Trolley Jack**

Stock No.31479

Part No.TJAS250

IMPORTANT: PLEASE READ THESE INSTRUCTIONS CAREFULLY TO ENSURE THE SAFE AND EFFECTIVE USE OF THIS PRODUCT.



CE

DRAPER®

GENERAL INFORMATION

These instructions accompanying the product are the original instructions. This document is part of the product, keep it for the life of the product passing it on to any subsequent holder of the product. Read all these instructions before assembling, operating or maintaining this product.

This manual has been compiled by Draper Tools describing the purpose for which the product has been designed, and contains all the necessary information to ensure its correct and safe use. By following all the general safety instructions contained in this manual, it will ensure both product and operator safety, together with longer life of the product itself. All photographs and drawings in this manual are supplied by Draper Tools to help illustrate the operation of the product. Whilst every effort has been made to ensure the accuracy of information contained in this manual, the Draper Tools policy of continuous improvement determines the right to make modifications without prior warning.



SCOPE

This jack is designed for light duty domestic use to lift vehicles to the maximum stated weight limit.



SPECIFICATION

Stock No.	31479
Part No.	TJAS250
Rated load	2500kg
Maximum lifting range	102-465mm

- **EXTREMELY IMPORTANT:** Read these safety instructions carefully in addition to the instructions for use, operation and maintenance. Keep this instructions sheet in an easy to find place as you may need to use it again.
 This jack has been designed for use in the elevation of vehicles.
 Any other application, beyond the conditions established for use of this jack will be considered inappropriate.
 Handle the jack correctly and ensure that all parts are in good condition prior to its use.
 Only authorised persons should operate the jack having read carefully and understood the contents of this manual.
 Do not modify the jack in any way.
 Non-compliance with these rules may result in injury or damage to the user, the jack or the vehicle to be lifted.
 The manufacturer accepts no responsibility for the improper use of the jack.



GUARANTEE

Draper tools have been carefully tested and inspected before shipment and are guaranteed to be free from defective materials and workmanship.

Should the tool develop a fault, please return the complete tool to your nearest distributor or contact Draper Tools Limited, Chandler's Ford, Eastleigh, Hampshire, SO53 1YF. England. Telephone Sales Desk: (023) 8049 4333 or Product Helpline (023) 8049 4344.

A proof of purchase must be provided with the tool.

If upon inspection it is found that a fault occurring is due to defective materials or workmanship, repairs will be carried out free of charge. The guarantee period covering parts/labour is 12 months from the date of purchase. The guarantee is extended to 24 months for parts only. This guarantee does not apply to normal wear and tear, nor does it cover any damage caused by misuse, careless or unsafe handling, alterations, accidents, or repairs attempted or made by any personnel other than the authorised Draper warranty repair agents.

Note: If the tool is found not to be within the Terms of Warranty, repair and carriage charges will be quoted and made accordingly.

This guarantee applies in lieu of any other guarantee expressed or implied and variations of its terms are not authorised.

Your Draper guarantee is not effective unless you can produce upon request a dated receipt or invoice to verify your proof of purchase within the guarantee period.

Please note that this guarantee is an additional benefit and does not affect your statutory rights.

Draper Tools Limited.

Note: This tool is intended for domestic use only.

SAFETY INSTRUCTIONS

- The vehicle to be lifted should never exceed the rated capacity of the jack.
- The maximum stroke of the jack indicated on the label should never be exceeded.
- The jack should be supported on a solid, level and horizontal surface which is well illuminated and free of obstructions. Never stand the jack on a surface which may sink.
Ensure that there are no persons inside the vehicle to be lifted. Switch off the engine and apply the brake. Ensure the vehicle or element to be lifted against any type of sliding. Use chocks if appropriate (1). Do not enter the vehicle or start the engine whilst it is supported on the jack or appropriate stands. The jack is a lifting device only and should never be used to move the vehicle.
- Position the jack under the manufacturer's recommended lifting point for the vehicle and ensure that it is not corroded, dirty or greasy. This point should remain centred over the jack saddle. All off-centred loads can slip and accidents may result.
- During raising and lowering of the load, all precautions should be taken to avoid movement of the vehicle load. Traffic may cause the raised vehicle to rock during roadside use of the jack.
- The jack should be positioned so as to avoid the need for the user to introduce any part of his/her body underneath the vehicle. Never work under a raised vehicle without supporting it with axle stands (3) or other appropriate methods. Never position any part of your body near the movable elements of the jack.
- It is necessary for the operator to be able to observe the lifting device and the load during all movements. In the presence of dangerous conditions, such as movement of the vehicle, etc, the lifting process must be interrupted.
- Ensure that there are no persons or obstructions underneath the vehicle prior to lowering.
- As an additional safety measure against overload, the jack is fitted with an overload valve set at the factory and which should not be adjusted under any circumstances. If the capacity of the jack is exceeded, the overload valve will stop the lifting operation.

USE AND OPERATION

- Prior to operating the jack, remove any accumulated air from the system as follows:
 - Insert the handle into the socket and fix it with the screw provided.
 - Pull the handle and turn it clockwise and, whilst held in this position, pump the jack several times to ensure internal lubrication and bleed the accumulated air from the system.
- Release the handle and it will automatically return back to the initial position ("Dead man principle"). The jack is now ready to be used.
- **IMPORTANT:** Prior to lifting the load, ensure that all of the aforementioned safety instructions are followed.
- The wheel of the jacks should always rotate freely.
- These jacks are fitted with a foot pedal that gives a faster approach to the load.
- For lifting, move the handle up and down (2), using the full stroke range of the piston for greater speed (2). Secure the lifted load as an essential safety measure with an appropriate axle stand (3).
- Before lowering, lift the vehicle to remove the axle stands, ensuring that there are no persons or obstacles under the vehicle to be lowered. Pull the handle and turn it clockwise (4).
- Our jacks are fitted with a safety device LCS that functions automatically and offers smooth and uniform lowering.
- Once the vehicle has been lowered release the handle and it will automatically return back to the initial position.

- **IMPORTANT:** Both the maintenance and repair of the jack may only be performed by qualified persons, who have sufficient knowledge of the hydraulic systems used in these devices as a result of their training and experience.
- Keep the jack clean and lubricate all moving parts at regular intervals (5), which must be clean and protected from aggressive conditions at all times.
- Only original spare parts should be used.
- Prior to each use, check for bent, broken, cracked or loose parts. Do not use if any defects are present. If it is suspected that the jack has been subjected to abnormal loads or has suffered any knocks, withdraw it from service until the problem has been rectified.
- If the oil level needs to be checked or refilled, with the piston fully retracted, remove the filler plug and drain its contents into a container. With the jack in a horizontal position, proceed to introduce the necessary volume of oil required.
- Make sure that no dirt enters with the new oil.
- Following a period of prolonged intensive use, it is recommendable to change the oil in order to extend the useful life of the jack.
- **IMPORTANT:** An excess of oil to the volume required may render the jack inoperative.
- Only use suitable hydraulic oil. **Never use brake fluid.**
- When the jack is not in use, make sure the lifting arm is fully retracted to avoid corrosion. Apply an anti-corrosion product to the pistons, if appropriate.
- Keep the jack in a clean, dry place and out of children reach. Remove the operating handle.
- At the end of the useful life of the jack, drain off the oil and hand it over to an authorised agent and dispose of the jack in accordance with local regulations.
- Both the repair kit, which exclusively contains the o-rings and seals of the jack, and the spare part sets must be ordered when servicing this jack.

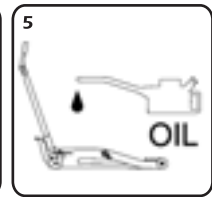
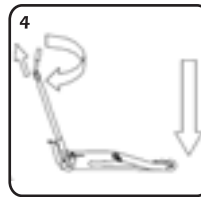
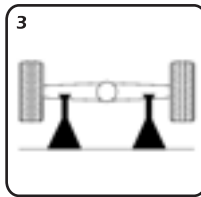
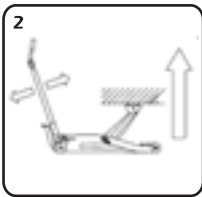
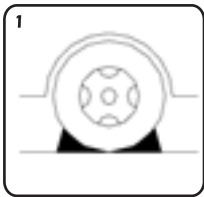

- At the end of the machine's working life, or when it can no longer be repaired, ensure that it is disposed of according to national regulations.
- Contact your local authority for details of collection schemes in your area.

In all circumstances:

- Do not dispose of tools with domestic waste.
 - Do not incinerate.
 - Do not abandon in the environment.
 - Remove oil from jack so it can be recycled.
-

- **DRAPER TOOLS LIMITED,**
Hursley Road, Chandler's Ford,
Eastleigh, Hampshire. SO53 1YF. U.K.
- **Helpline:** (023) 8049 4344
- **Sales Desk:** (023) 8049 4333
- **General Enquiries:** (023) 8026 6355
- **Fax:** (023) 8026 0784
- **Internet:** www.drapertools.com
- **E-mail:** sales@drapertools.com
- **Service/Warranty Repair Agent**
For aftersales servicing or warranty repairs, please contact the Draper Tools Helpline for details of an agent in your local area.

YOUR DRAPER STOCKIST

PJDH030913