



**DRAPER**<sup>®</sup>

**STORMFORCE**

230V

# WALLPAPER STEAMER

84434



These instructions accompanying the product are the original instructions. This document is part of the product, keep it for the life of the product passing it on to any subsequent holder of the product. Read all these instructions before assembling, operating or maintaining this product.

This manual has been compiled by Draper Tools describing the purpose for which the product has been designed, and contains all the necessary information to ensure its correct and safe use. By following all the general safety instructions contained in this manual, it will ensure both product and operator safety, together with longer life of the product itself.

All photographs and drawings in this manual are supplied by Draper Tools to help illustrate the operation of the product.

Whilst every effort has been made to ensure the accuracy of information contained in this manual, the Draper Tools policy of continuous improvement determines the right to make modifications without prior warning.

# 1. TITLE PAGE

---

## 1.1 INTRODUCTION:

**USER MANUAL FOR: 230V Wallpaper Steamer**

**Stock No: 84434**

**Part No: WPS2000**

## 1.2 REVISIONS:

---

**Date first published June 2018.**

---

**Date first revised February 2020.**

---

---

As our user manuals are continually updated, users should make sure that they use the very latest version.

**Downloads are available from:** <http://drapertools.com/manuals>

Draper Tools Limited

Hursley Road

Chandler's Ford

Eastleigh

Hampshire

SO53 1YF

UK

**Website:** [drapertools.com](http://drapertools.com)

**Product Help Line:** +44 (0) 23 8049 4344

**General Fax:** +44 (0) 23 8026 0784

## 1.3 UNDERSTANDING THIS MANUAL'S SAFETY CONTENT:

**WARNING!** – Information that draws attention to the risk of injury or death.

**CAUTION!** – Information that draws attention to the risk of damage to the product or surroundings.

## 1.4 COPYRIGHT © NOTICE:

Copyright © Draper Tools Limited.

Permission is granted to reproduce this publication for personal and educational use only. Commercial copying, redistribution, hiring or lending is prohibited.

No part of this publication may be stored in a retrieval system or transmitted in any other form or means without written permission from Draper Tools Limited.

In all cases this copyright notice must remain intact.

---

## 2. CONTENTS

---

<b>1</b>	<b>TITLE PAGE</b>	
1.1	INTRODUCTION.....	2
1.2	REVISIONS.....	2
1.3	UNDERSTANDING THIS MANUAL'S SAFETY CONTENT.....	2
1.4	COPYRIGHT NOTICE.....	2
<b>2</b>	<b>CONTENTS</b>	
2.1	CONTENTS.....	3
<b>3</b>	<b>WARRANTY</b>	
3.1	WARRANTY.....	4
<b>4</b>	<b>INTRODUCTION</b>	
4.1	SCOPE.....	5
4.2	SPECIFICATION.....	5
4.3	HANDLING & STORAGE.....	5
<b>5.</b>	<b>HEALTH &amp; SAFETY INFORMATION</b>	
5.1	GENERAL SAFETY INSTRUCTIONS FOR POWER TOOL USE.....	6
5.2	SPECIFIC SAFETY INSTRUCTIONS FOR WALLPAPER STEAMER USE.....	7
5.3	RESIDUAL RISK.....	8
5.4	CONNECTION TO THE POWER SUPPLY.....	8
<b>6.</b>	<b>TECHNICAL DESCRIPTION</b>	
6.1	IDENTIFICATION.....	9
<b>7.</b>	<b>UNPACKING &amp; CHECKING</b>	
7.1	PACKAGING.....	10
7.2	WHAT'S IN THE BOX.....	10
<b>8.</b>	<b>SETTING UP THE STEAMER</b>	
8.1	ATTACHING THE STEAM PLATES AND 'COOL-TOUCH' HOSE.....	11
<b>9.</b>	<b>OPERATING THE STEAMER</b>	
9.1	FILLING WITH HOT WATER.....	12
9.2	ATTACHING THE POWER LEAD.....	12
9.3	PREPARATION.....	13
9.4	STRIPPING.....	13
9.5	REFILLING AND EMPTYING.....	13
<b>10.</b>	<b>MAINTENANCE</b>	
10.1	MAINTENANCE.....	14
10.2	TROUBLESHOOTING.....	14
<b>11.</b>	<b>DISPOSAL</b>	
11.1	DISPOSAL.....	14
<b>12.</b>	<b>EXPLANATION OF SYMBOLS</b>	
12.1	EXPLANATION OF SYMBOLS.....	15
	<b>DECLARATION OF CONFORMITY</b> .....	ENCLOSED

## 3. WARRANTY

---

### 3.1 WARRANTY

Draper tools have been carefully tested and inspected before shipment and are guaranteed to be free from defective materials and workmanship.

Should the tool develop a fault, please return the complete tool to your nearest distributor or contact

**Draper Tools Limited, Chandler's Ford, Eastleigh, Hampshire, SO53 1YF. England.**

**Telephone Sales Desk: (023) 8049 4333 or Product Help Line (023) 8049 4344.**

A proof of purchase **must** be provided with the tool.

If upon inspection it is found that the fault occurring is due to defective materials or workmanship, repairs will be carried out free of charge. This warranty period covering labour is 12 months from the date of purchase except where tools are hired out when the warranty period is 90 days from the date of purchase. The warranty is extended to 24 months from the date of purchase for parts only. This warranty does not apply to any consumable parts, any type of battery or normal wear and tear, nor does it cover any damage caused by misuse, careless or unsafe handling, alterations, accidents, or repairs attempted or made by any personnel other than the authorised Draper warranty repair agent.

**Note:** If the tool is found not to be within the terms of warranty, repairs and carriage charges will be quoted and made accordingly.

This warranty applies in lieu of any other warranty expressed or implied and variations of its terms are not authorised.

Your Draper warranty is not effective unless you can produce upon request a dated receipt or invoice to verify your proof of purchase within the warranty period.

Please note that this warranty is an additional benefit and does not affect your statutory rights.

**Draper Tools Limited.**

## 4. INTRODUCTION

---

### 4.1 SCOPE

The wallpaper steamer described in the manual is designed for fast and efficient removal of most types of wallpaper and other decorative surfaces.

This product is intended for domestic and infrequent light trade use only. Any application other than that it was intended for, is considered misuse.

### 4.2 SPECIFICATION

Stock No. ....	84434
Part No. ....	WPS2000
Rated voltage .....	230V~50Hz
Rated input .....	2000W
Water tank capacity.....	4.5 litres
Heat up time .....	10mins (approx.)
Single fill duration .....	60mins (approx.)
Safety cutout feature .....	@ 105°C
Protection rating .....	IPX4
Weight (empty tank & 2 steam plates.....	1.4kg

### 4.3 HANDLING & STORAGE

- Care must be taken when handling this product. Dropping this power tool could have an effect on its accuracy and could also result in personal injury. This product is not a toy and must be respected.
- Environmental conditions can have a detrimental effect on this product if neglected. Exposure to damp air can gradually corrode components. If the product is unprotected from dust and debris, components will become clogged. If not cleaned and maintained correctly or regularly, the machine will not perform at its best.
- Without regular cleaning, debris can clog the machine resulting in poor performance.

## 5. HEALTH AND SAFETY INFORMATION

---

### 5.1 GENERAL SAFETY INSTRUCTIONS FOR POWER TOOL USE

**Warning:** Read all safety warnings and all instructions. Failure to follow the warnings and instructions may result in electric shock, fire and/or serious injury.

**Save all warnings and instructions for future reference.**

The term “power tool” in the warnings refers to your mains operated (corded) power tool or battery-operated (cordless) power tool, in this case it refers to a wallpaper steamer.

#### 1) Work area safety

- a) Keep work area clean and well lit. Cluttered or dark areas invite accidents.
- b) Do not operate power tools in explosive atmospheres, such as in the presence flammable liquids, gases or dust. Power tools create sparks which may ignite the dust or fumes.
- c) Keep children and bystanders away while operating a power tool. Distractions can cause you to lose control.

#### 2) Electrical safety

- a) Power tool plugs must match the outlet. Never modify the plug in any way. Do not use any adapter plugs with earthed (grounded) power tools. Unmodified plugs and matching outlets will reduce risk of electric shock.
- b) Avoid body contact with earthed or grounded surfaces such as pipes, radiators, ranges and refrigerators. There is an increased risk of electric shock if your body is earthed or grounded.
- c) Do not expose power tools to rain or wet conditions. Water entering a power tool will increase the risk of electric shock.
- d) Do not abuse the cord. Never use the cord for carrying, pulling or unplugging the power tool. Keep cord away from heat, oil, sharp edges or moving parts. Damaged or entangled cords increase the risk of electric shock.
- e) When operating a power tool outdoors, use an extension cord suitable for outdoor use. Use of a cord suitable for outdoor use reduces the risk of electric shock.
- f) If operating a power tool in a damp location is unavoidable, use a residual current device (RCD) protected supply. Use of an RCD reduces the risk of electric shock.

#### 3) Personal safety

- a) Stay alert, watch what you are doing and use common sense when operating a power tool. Do not use a power tool while you are tired or under the influence of drugs, alcohol or medication. A moment of inattention while operating power tools may result in serious personal injury.
- b) Use personal protective equipment. Always wear eye protection. Protective equipment such as dust mask, non-skid safety shoes, hard hat, or hearing protection used for appropriate conditions will reduce personal injuries.
- c) Prevent unintentional starting. Ensure the switch is in the off position before connecting to power source and/or battery pack, picking up or carrying the tool. Carrying power tools with your finger on the switch or energising power tools that have the switch on invites accidents.
- d) Remove any adjusting key or wrench before turning the power tool on. A wrench or a key left attached to a rotating part of the power tool may result in personal injury.
- e) Do not overreach. Keep proper footing and balance at all times. This enables better control of the power tool in unexpected situations.
- f) Dress properly. Do not wear loose clothing or jewellery. Keep your hair, clothing and gloves away from moving parts. Loose clothes, jewellery or long hair can be caught in moving parts.
- g) If devices are provided for the connection of dust extraction and collection facilities, ensure these are connected and used properly. Use of these devices can reduce dust-related hazards.

## 5. HEALTH AND SAFETY INFORMATION

---

### 4) Power tool use and care

- a) Do not force the power tool. Use the correct power tool for your application. The correct power tool will do the job better and safer at the rate for which it was designed.
- b) Do not use the power tool if the switch does not turn it on and off. Any power tool that cannot be controlled with the switch is dangerous and must be repaired.
- c) Disconnect the plug from the power source and/or battery pack from the power tool before making any adjustments, changing accessories, or storing power tools. Such preventive safety measures reduce the risk of starting the power tool accidentally.
- d) Store idle power tools out of the reach of children and do not allow persons unfamiliar with the power tool or these instructions to operate the power tool. Power tools are dangerous in the hands of untrained users.
- e) Maintain power tools. Check for misalignment or binding of moving parts, breakage of parts and any other condition that may affect the power tool's operation. If damaged, have the power tool repaired before use. Many accidents are caused by poorly maintained power tools.
- f) Keep cutting tools sharp and clean. Properly maintained cutting tools with sharp cutting edges are less likely to bind and are easier to control.
- g) Use the power tool, accessories and tool bits etc. in accordance with these instructions, taking into account the working conditions and the work to be performed. Use of the power tool for operations different from those intended could result in a hazardous situation.

### 5) Service

- a) Have your power tool serviced by a qualified repair person using only identical replacement parts. This will ensure that the safety of the power tool is maintained.

### IMPORTANT

**If using an extension lead, follow the instructions that came with your lead regarding maximum load while cable is wound. If in doubt, ensure that the entire cable is unwound. Using a coiled extension lead will generate heat which could melt the lead and cause a fire.**

### 5.2 SPECIFIC SAFETY INSTRUCTIONS FOR WALLPAPER STEAMER USE

- Keep equipment away from children and pets.
- Ensure boiler is placed on a flat level surface, and should the boiler become tilted in use - level again immediately.  
Failure to do so can result in severe overheating, complete element failure and void of your guarantee.
- Block boiler unit securely if using on stairs.
- The boiler becomes hot in use. Move only by using the carrying handle.
- Steam is produced at 100°C. Be careful, wear protective clothing and protect your hands with heat resistant gloves or mitts.
- Never point hose or steam plate at anyone.
- Always keep steam plate tilted away from face and body, beware of hot drips and regularly empty collected condensation from plate - especially when stripping ceilings and high areas.
- Never remove filler cap or detach hose whilst unit is operating.
- Never block the safety valve.
- Switch off and wait for 2 minutes before removing filler cap to refill boiler.
- Do not overfill.
- Allow to cool completely before emptying boiler.
- Do not stand on boiler or hose.
- Do not drag or try to move boiler by pulling the mains lead.

## 5. HEALTH AND SAFETY INFORMATION

---

- Do not allow water or steam to enter light switches or power points.
- Do not leave unattended.
- Use only standard tap water. Never add detergents or chemicals.
- Extreme care must be taken if the unit is used in bathrooms. Always be aware of danger of electrocution from stored water in baths and sinks.
- Never change tools when the unit is operating.
- Always store upright.
- Do not overfill the reservoir.
- It is recommended that a RCD (residual current device) rated at 30mA is fitted into the mains supply socket for added protection against electric shock.
- Check the state of your plaster before starting work.  
**Warning!** Steam can loosen weak, porous or poorly bonded plaster – which also loosens readily if cracked, holed or if the steam plate is held in one position for too long after the paper is soaked.
- Weak plaster can normally be detected by tapping a few areas of wall. A hollow sound indicates that you should proceed only with extreme care - stopping immediately if you hear a cracking sound or plaster starts to break loose.
- The steam stripper is safe for drywall/plaster board surfaces, but whatever the material, it is always wise to check a small area before starting work properly.

### 5.3 RESIDUAL RISK

**Important note:** Although the safety instructions and operating manuals for our tools contain extensive instructions of safe working with power tools, every power tool involves a certain residual risk which can not be completely excluded by safety mechanisms. Power tools must therefore always be operated with caution!

### 5.4 CONNECTION TO THE POWER SUPPLY

Make sure the power supply information on the machine's rating plate are compatible with the power supply you intent to connect it to.

This product comes supplied with a UK standard 3 pin plug. It is designed for connection to a domestic power supply rated at 230V AC.

This appliance is Class I† and is designed for connection to a power supply matching that detailed on the rating label and compatible with the plug fitted.

†Earthed : This product requires an earth connection to protect against electric shock from accessible conductive parts in the event of a failure of the basic insulation.

If an extension lead is required, use an approved and compatible lead rated for this appliance.

Follow all the instructions supplied with the extension lead. If using an extension lead, follow the instructions that came with your lead regarding maximum load while cable is wound, if in doubt ensure that the entire cable is unwound. Using a coiled extension lead will generate heat which could melt the lead and cause a fire.

#### IMPORTANT

**If using an extension lead, follow the instructions that came with your lead regarding maximum load while cable is wound. If in doubt, ensure that the entire cable is unwound. Using a coiled extension lead will generate heat which could melt the lead and cause a fire.**



## 6. TECHNICAL DESCRIPTION

### 6.1 IDENTIFICATION



- ① Hose connection/outlet.
- ② Filler cap.
- ③ Carrying handle.
- ④ Power socket.
- ⑤ Water reservoir (4.5 litre capacity).
- ⑥ Small steam plate.
- ⑦ Large steam plate.
- ⑧ 3M (approx.) 'Cool-touch' steam hose.

## 7. UNPACKING AND CHECKING

---

### 7.1 PACKAGING

Carefully remove the product from the packaging and examine it for any sign of damage that may have happened during shipping. Lay the contents out and check them against the parts shown below. If any part is damaged or missing, please contact the Draper Help Line (the telephone number appears on the Title page) and do not attempt to use the product.

The packaging material should be retained at least during the guarantee period in case the machine needs to be returned for repair.

**Warning!** Some of the packaging materials used may be harmful to children. Do not leave any of these materials in the reach of children.

If any of the packaging is to be thrown away, make sure they are disposed of correctly, according to local regulations.

### 7.2 WHAT'S IN THE BOX

As well as the product, there are several parts not fitted or attached to it.

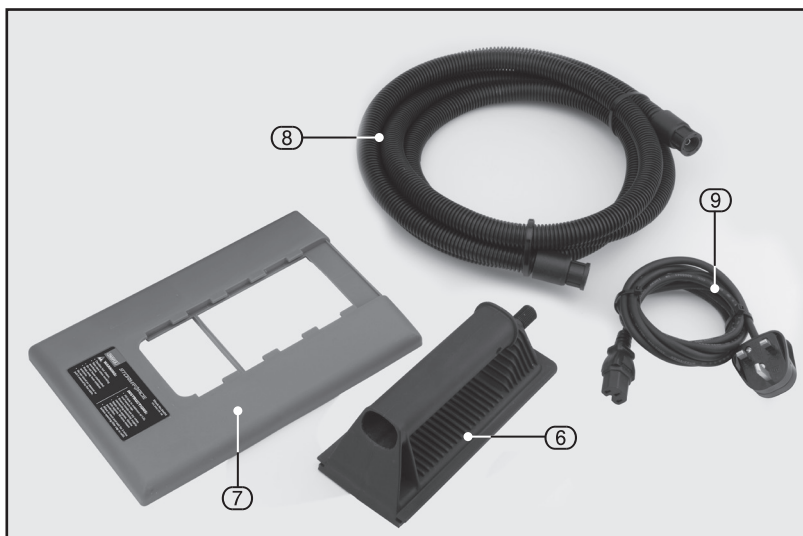

- ⑥ Small steam plate.
- ⑦ Large steam plate.
- ⑧ 3M (approx.) 'Cool-touch' steam hose.
- ⑨ 2M (approx.) power cable.

## 8. PREPARING THE WALLPAPER STEAMER

### Warning!

- Ensure boiler is placed on a flat level surface, and should the boiler become tilted in use – level again immediately.
- Failure to do so can result in severe overheating, complete element failure and void of your guarantee.

**Note:** Remove the plug from the socket before carrying out adjustment, servicing or maintenance.

### 8.1 ATTACHING THE STEAM PLATES AND 'COOL-TOUCH' HOSE – FIGS. 1 – 3

- Attach 'cool-touch' hose (8) to the hose connection/outlet (1) at one end.
- At the remote end attach 'cool-touch' hose (8) to small steam plate (6).

**Note:** If you want to use the large steam plate (7) then the small steam plate (6) has to be located within it (see Fig.3).

**Note:** Reverse this action to use the small steam plate only (6).

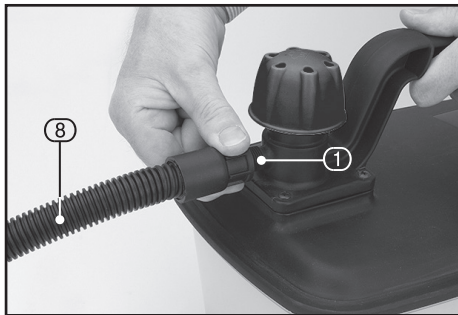

FIG.1



FIG.2

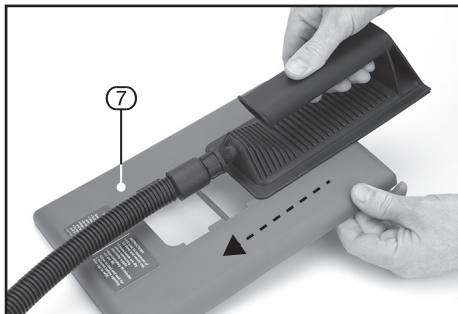

FIG.3

## 8. PREPARING THE WALLPAPER STEAMER

**Note:** Do not leave unattended and keep children and pets out of the room.

### 9.1 FILLING WITH HOT WATER – FIGS. 4 – 5

- Remove the reservoir cap (2) and pour in the tap water (preferably hot, max 4.5 litres), avoiding spillage.
- Do not overfill the unit or hot water will be forced up the steam hose. Observe the level indicator (5.1) on the side of the reservoir (5) when filling.
- Ensure the cap is replaced and secured tightly but do not over tighten. **Never use this unit with the cap missing or loose.** Do not fill past the maximum mark.

**Note:** Ensure the unit and your hands are fully dry prior to plugging in.

**Warning!** Beware of hot water discharge prior to steam emission.

**Warning!** Only operate this machine by placing it on a stable flat surface.

### 9.2 ATTACHING THE POWER LEAD – FIG. 6

Plug the adaptor end of the power lead (9) into socket (4). It is advisable to use a residual current device (RCD - Draper Stock No.69307) in conjunction with this unit.

**Note:** This unit will automatically begin the boiling process when power is switched on at the mains socket.



FIG.4



FIG.5

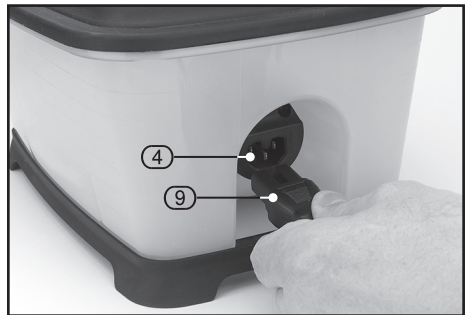

FIG.6

## 9. OPERATING THE WALLPAPER STEAMER

### 9.3 PREPARATION

**Important:** Ensure boiler is placed on a flat, level surface. Should the boiler become tilted in use - level again immediately. Failure to do so can result in severe overheating, complete element failure and void of your warranty.

To achieve fastest paper removal always gently score the areas to be stripped.

With heavily embossed, vinyl coated or painted papers this is essential. Either use a proprietary perforation tool or alternatively score the paper with the edge of a wall scraper in a criss-cross pattern with 150mm (6 inch) spacing.

As with all decorating work be sure to protect carpets and furniture with covers. Please check [drapertools.com](http://drapertools.com) for all these decorating accessories.

**Note:** You should only proceed at your own risk.

### 9.4 STRIPPING - FIG. 7

Whilst the unit is heating the water to boiling point (approx.10mins), do not leave the steam plate resting down or unattended. When boiling point is reached, take care as boiling water droplets can be expelled from the steam plate/hose area. This coughing and spluttering is normal, but be careful – **the water/steam is hot.**

- When constant steam is being produced, place the steam plate flat against the work surface. It is advisable to carry out a test on the surface to be worked on.
- Hold the steam plate against the area for no more than 10secs. Assess the porosity of the surface.
- Based on these results continue accordingly.

**Note:** Always wear suitable heat resistant gloves and a long sleeved top. Beware of hot water accumulating in the steam plate as this could cause scolding if spilt.

**RISK OF ELECTRIC SHOCK!** Do not allow steam or water droplets near or into electrical outlets or fittings.

### 9.5 REFILLING AND EMPTYING – FIG. 8

- Switch off and unplug the unit when the water level is low or when the automatic cut-off functions. Do not use the unit with the water level below min.
- Allow the water to cool down for 5mins before removing the cap. Wear gloves to do this. Refill the unit according to instructions on page 13.
- To empty the machine, allow the water to cool fully before attempting. Tip the water back out through the inlet.
- Should the machine cut out at any stage during operation, switch off and unplug the power lead from the socket.
- Allow the machine to rest/cool for approximately 10 – 15mins and the thermal cut-out will reset.

**Note:** The cut-out will not protect against the heating element being exposed out of the water for longer than 5 seconds. Any longer exposure will cause damage to the unit.

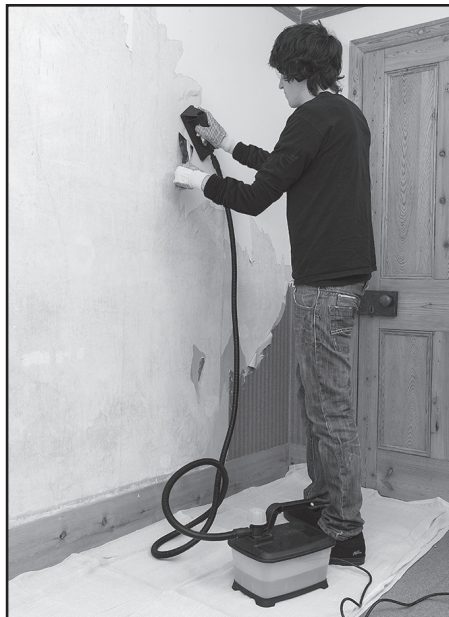

FIG.7



FIG.8

# 10. MAINTENANCE AND TROUBLESHOOTING

## 10.1 MAINTENANCE

Regular inspection and cleaning reduces the necessity for maintenance operations and will keep your tool in good working condition.

When using this product in hard water, heavy limescale areas, it is advisable to periodically de-scale the heating element. Use of a proprietary brand of kettle descaler is recommended. Always follow the manufacturer's instructions when using such products.

## 10.2 TROUBLESHOOTING

**Note:** Remove the plug from the socket before carrying out adjustment, servicing or maintenance.

Problem	Possible Cause	Remedy
Steamer fails to boil.	<ol style="list-style-type: none"><li>1. Safety cut out in operation.</li><li>2. Blown fuse in plug, or interruption to power supply .</li></ol>	<ol style="list-style-type: none"><li>1. Leave to cool for 10 – 15mins until reset.</li><li>2. Check/replace fuse in plug, and/or power supply.</li></ol>
Steam leaking from pressure relief valve.	Blockage in steam hose or steam plate outlet.	Check hoses/attachments and if necessary, remove any blockages.

# 11. DISPOSAL

## 11.1 DISPOSAL

- At the end of the machine's working life, or when it can no longer be repaired, ensure that it is disposed of according to national regulations.
- Contact your local authority for details of collection schemes in your area.

In all circumstances:

Do not dispose of power tools with domestic waste.

Do not incinerate.

Do not dispose of WEEE\* as unsorted municipal waste.



\* Waste Electrical & Electronic Equipment.

# 12. EXPLANATION OF SYMBOLS

---

## 12.1 EXPLANATION OF SYMBOLS



Read the instruction manual.



Wear protective gloves.



Do not abandon into the environment.



Keep out of the reach of children.



**Warning!**



Water ingress protection rating.



Earthed connection.



WEEE –

Waste Electrical &  
Electronic Equipment.

*Do not dispose of Waste Electrical  
& Electronic Equipment in with  
domestic rubbish.*

## CONTACTS

Draper Tools Limited, Hursley Road,  
Chandler's Ford, Eastleigh, Hampshire. SO53 1YF. U.K.

Help Line: (023) 8049 4344

Sales Desk: (023) 8049 4333

Internet: [drapertools.com](http://drapertools.com)

E-mail: [sales@drapertools.com](mailto:sales@drapertools.com)

General Enquiries: (023) 8026 6355

Service/Warranty Repair Agent:

For aftersales servicing or warranty repairs, please contact the  
Draper Tools Help Line for details of an agent in your local area.

## YOUR DRAPER STOCKIST

TACM0220

©Published by Draper Tools Limited.

No part of this publication may be reproduced, stored in a retrieval system or transmitted in any form or by any means, electronic, mechanical photocopying, recording or otherwise without prior permission in writing from Draper Tools Ltd.